

POWER & HAND SWAGERS



**POWER SWAGER
Model PS280**



**POWER SWAGER
Model PS215**



**HAND SWAGER
Model HS215**

WNS Swaging machines are built for productivity and long working life. Many different profiles can be achieved with different types of rolls.

All forming rolls are hardened for long life. The power machine has two models, PS 280 and PS 215. PS 215 comes with fixed speed of about 20rpm and PS 280 comes variable speed 0 - 40 rpm.

Foot Pedal for forward & reverse; 415V/ 3 ph/ 50 hz; Low Voltage (24 V) Foot Control, complete with 1 set of rolls.

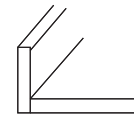

Jennying/
Flanging

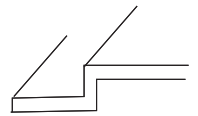

Necking/
Jogging

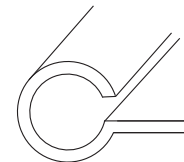

Wiring

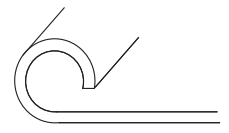

Closing



Swaging



Crimping

SPECIFICATIONS

MODEL	PS 280	PS 215	HS 215
Capacity	2 mm	1.2 mm	1.2 mm
Throat	280 mm	215 mm	215 mm
Width	400 mm	310 mm	508 mm
Height	1,100 mm	1,200 mm	485 mm
Weight	165 Kg	90 kg	Approx. 35 kgs
Power (3 ph/ 415 V/ 50Hz)	1 HP	0.5 HP	

Ductfab Equipments Pvt Ltd
(Formerly W. Neal Services (India) Pvt Ltd)

A-40, ADDITIONAL M.I.D.C., ANAND NAGAR, AMBERNATH - 421 501. (INDIA)

Factory Mobile No. 0091-9322734824 / 08369526048.

Email : sales@ductfab.in Website : www.ductfab.in